

Gasic, Drazen

From: Scannell, Luke W (DEC) <luke.scannell@dec.ny.gov>
Sent: Friday, December 18, 2020 8:22 AM
To: Gasic, Drazen
Subject: Re: NYSDEC Solar Guidance
Attachments: 20200916_145002.jpg; 20200916_145004.jpg

Categories: Resources

Drazen,

Yes, that is essentially correct for point 1. For point 2 we don't recommend trying to use water bars as level spreaders, use either or. More formally:

In the NYSDEC Region 8, we are currently willing to accept the following design criteria in regard to solar panel installations:

1. On 5-10% slopes it is our experience that solar panel projects with the panels arranged as shown in the attached photos, including a 1" gap between panels, will avoid creating concentrated flow paths on a well vegetated site. In such cases, flow diffusers, or other dripline features are not required as suggested in the Maryland Solar Guidance.

However, if the topography of the slope is such that it concentrates flows coming off the panels, other erosion controls may be necessary. Additionally, temporary stabilization will be needed on erosive soils until a dense vegetated cover can be established.

2. On slopes 10% or greater, additional controls are required. These can take the form of water bars or level spreaders. We are not recommending that water bars be used as level spreaders. For both practices they should be implemented across the slope at the recommended frequency as indicated in the Blue Book detail for water bars. That is every 75' for slopes between 10 and 20%.

In all instances, if erosion is observed to be occurring despite implementation of planned erosion and sediment controls, additional measures should be considered and implemented to minimize soil erosion and offsite transport.

Regards,

Luke

From: Gasic, Drazen <DGasic@LaBellaPC.com>
Sent: Thursday, December 17, 2020 5:05 PM
To: Scannell, Luke W (DEC) <luke.scannell@dec.ny.gov>
Subject: NYSDEC Solar Guidance

ATTENTION: This email came from an external source. Do not open attachments or click on links from unknown senders or unexpected emails.

Luke,

Could you confirm my understanding below based on our solar discussion, as potential additional guidance that may be accepted if we coordinated with the regional DEC official? We are looking to make a submission to MS4s as well, and at the time, we may request that we have a conference call about the proposed design with the MS4 and the regional DEC official.

Update 1: If the developer is able to provide a min. 1-inch space between the modules horizontally, then the DEC would be willing to consider not requiring flow diffusers for slopes between 5-10%. The rationale for this is that having the gap breaks up the potential accumulated sheet flow created on the modules. The DEC is also in favor of the modules being in landscape over portrait as that again reduces the surface sheet flow on the modules.

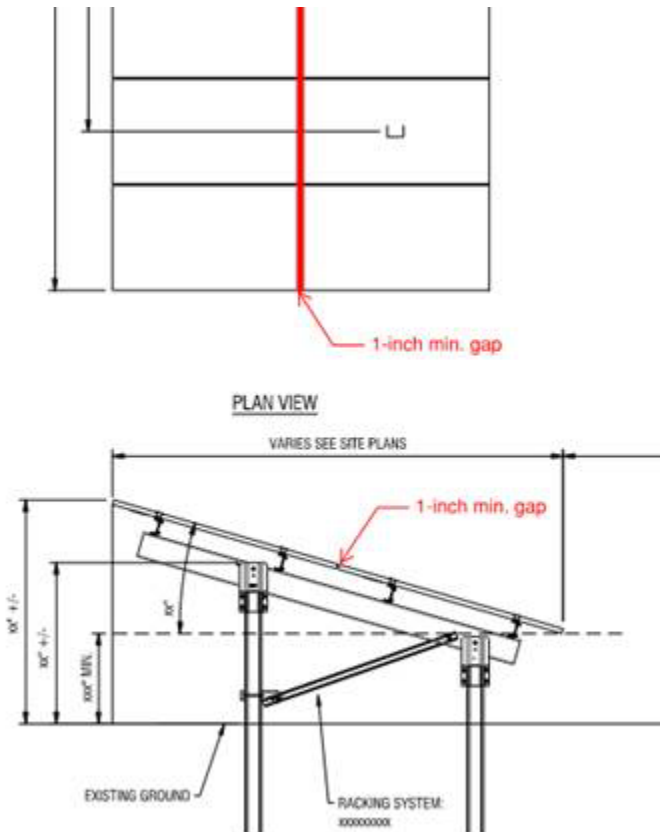

Update 2: If we need to place modules in slopes greater than 10%, the DEC is willing to review calculations for water bars that are sized and designed based on the NYS Erosion Control Book (Blue Book) with the attached clarification. . The intention is to make the water bar parallel to the contour with as close to 0% cross slope, and allow water to transition from shallow concentrated flow, from solar panels, to sheet flow.

Thank you
-Drazen

Drazen Gasic, CPSWQ, CPESC

LaBella Associates | Civil Renewable Manager | Civil Engineer



585-402-7005 direct